

TD-0350

DESK BOOKING PANEL-PC

Applications

HOT DESKING

Applications

DESK HOTELING

Applications

CO-WORK SPACE

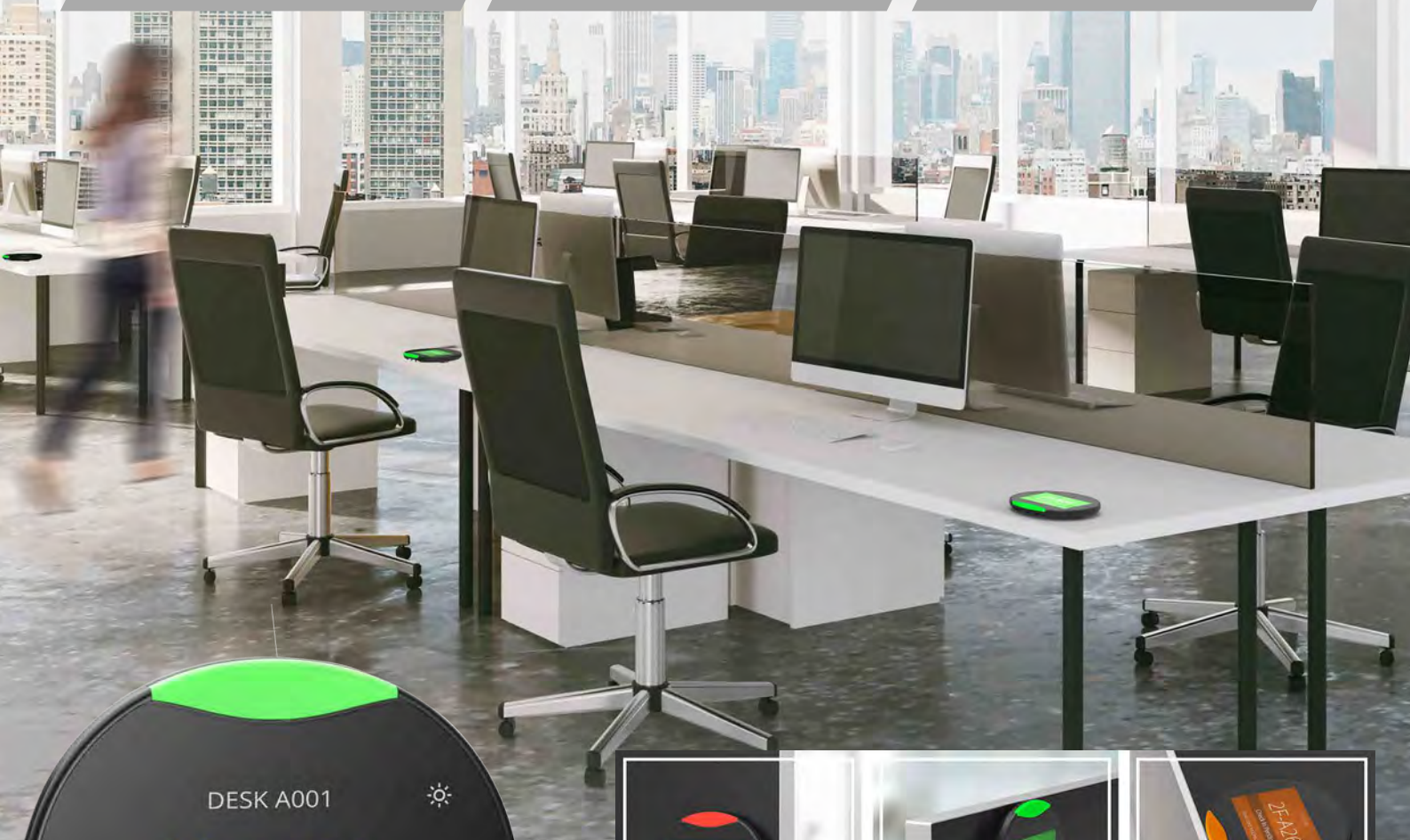

Meeting rooms



Desk partition/
Dividers



Desk surfaces



NFC



Multi touch



3.5" LCD
screen



Noise
reduction mic.



Internal
speaker



WiFi



Status LED
lights



180°
orientation



Tamper
proof



Water
resistant



RFID (NFC)
card reader

RFID (NFC) CARD READER

User authentication is made easy with the Qbic TD-0350 Panel. If you enable user authentication, users need to scan their RFID card or type in their personal pin code before a booking can be made. The RFID card reader allows users to check-in, book, extend and end their bookings with their RFID card.

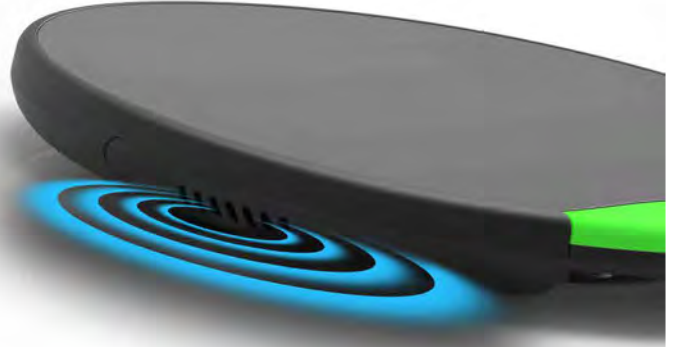

INTERNAL SPEAKER

Our desk booking touch display is designed to mount on any surface. The installation is very easy and does not cause any damages or permanent markings on the surface.



SKYPE SUPPORTED

Skype is supported and made even more convenient with onboard speaker, noise reduction microphone and additionally, headsets can be plugged in for privacy conference calls.

TAMPER PROOF

Our desk booking touch display is designed to safe mount on any surface. USB power cords are specifically designed to be tamper-proof to prevent any theft and vandalism to the device.

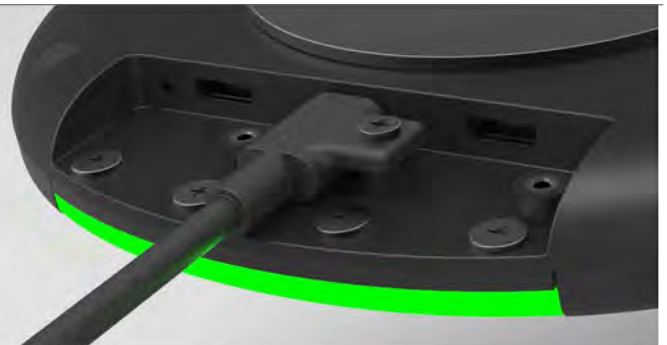

WATER RESISTANT

Your asset is well protected from any un-intended liquid or coffee spills while you're working on a drowning pile of paperwork. No one likes to see that happen, but its a good piece of mind knowing your electronic devices are safe from liquid damages.

AESTHETICS

Aesthetically designed with ultra slim form factor which makes the TD-0350 the slimmest and the only dedicated desk booking device on the market.

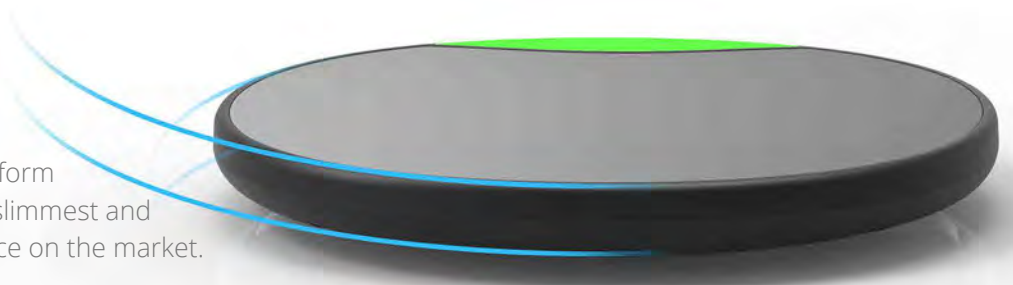

DESK BOOKING AT A BREEZE

From the desk booking panel, you can easily book your desk for a couple of hours or for the entire day. Do you need your desk for a longer time than expected? Don't worry. Just extend your booking directly from the display.

Easily locate your seat or space from the front brightly lit LED status light and LCD screen to identify the space.

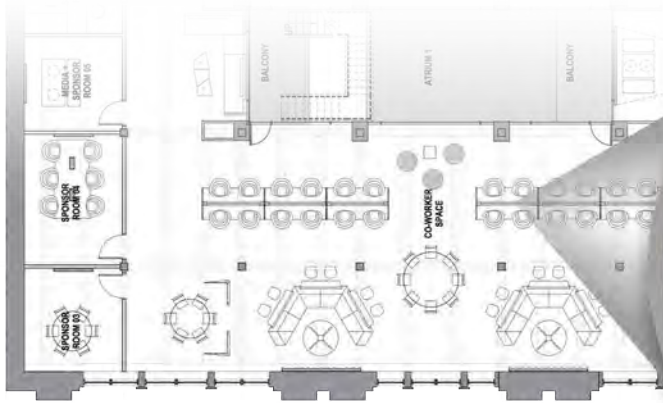

Vibrant LED Status Lights
(256 colors)



API SUPPORT

Software integration is simple, we provide partners with our API and source codes. It also enables managing, controlling, setting multiple devices anywhere at anytime, including remote firmware updates via web-based system.

EASY MOUNTING

Our desk booking touch display is designed to mount on any surface. The installation is very easy and does not cause any damages or permanent markings on the surface. The USB power cord is specifically designed to be tamper-proof to prevent any vandalism to the device. The desk booking panel connects to your network via WIFI.



Mounting bracket included.

SPECIFICATIONS

Processor	ARM Quad-core 1.6GHz
OS	Android 5.1/ Android 7.1
API	HTML5 / Android API
Memory	1GB DDR3L
Storage	8GB eMMC
Display	3.5", 480 x 320 px, Multi-touch, 350 nits, IPS Direct-bonding
RFID	13.56 MHz and 125 KHz (HID technology support opt.)
Network	WLAN 802.11 b/g/n, single band 2.4GHz
IO Ports	1 x Micro USB for Power-in
	1 x Micro USB for ADB
	1 x Micro USB for Host
Dimension	122mm x 116mm x 13mm (4.8" x 4.56" x 0.5")
Operating Temp.	0~50°C (32~122°F)
Certificate	CE/FCC/RoHS/BSMI/NCC/IMDA/CCC/VCCI

